

Alex. Edwards.  
D-85-237

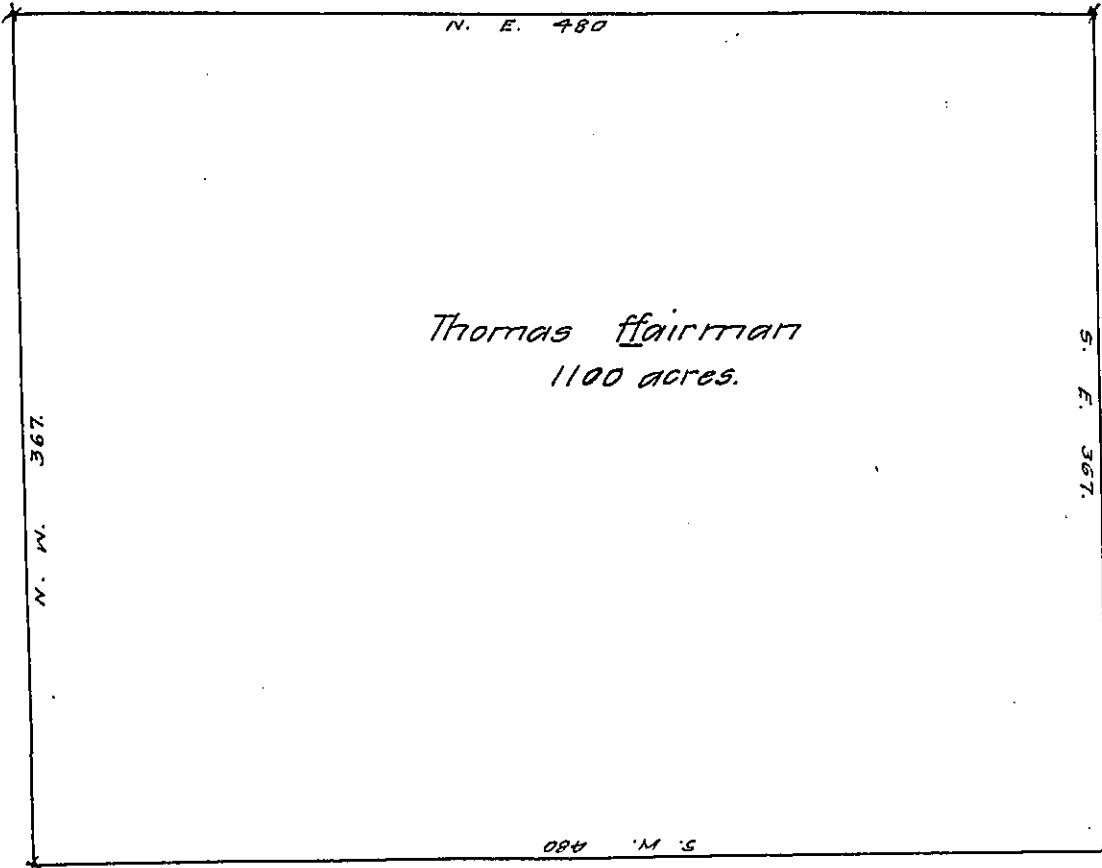

Robt Fairman Jo<sup>r</sup> Burts

Tho. Lewis

Pursuant to a warrant from the Proprietary Commiss<sup>rs</sup> of property bearing date ye 16 of ye 9<sup>th</sup> mo. 1702 directed unto mee. I do certify that there was Resurveyed unto Thomas Fairman a certaine tract of land in the County of Philadelphia being part of Will<sup>m</sup> Stamly's purchases beginning at a stake being a corner deviding it from Thomas Lewis land from thence by a line of marked trees north west 367 perches to another stake deviding it from Alexander ~~Edwards~~ Edward land from thence by a line of marked trees and ye same land northeast 480 perches to another stake sett in a line deviding it from Robert Fairman's land from thence by a line of marked trees and ye same land and ye land of John Barnes & Will<sup>m</sup> Dillin south east 369 perches to another stake deviding it from the said ~~tho~~ Thomas Lewis land from thence by a line of marked trees & ye same land south west 480 perches to ye place of beginning containing 1100 acres of land and is according to ye bounds above described returned into the Generall Survey<sup>r</sup> office at Philadelphia ye 19<sup>th</sup> day of ye 9<sup>th</sup> mo. 1702.

pr. David Powell.

N. p<sup>d</sup>

IN TESTIMONY that the above is a copy of the original remaining on file in the Department of Internal Affairs of Pennsylvania, made conformably to an Act of Assembly approved the 16th day of February, 1833, I have hereunto set my Hand and caused the Seal of said Department to be affixed at Harrisburg, this twenty-second day of June 1909.

*Henry Howell*  
Secretary of Internal Affairs.